



Installationsanleitung Instructions d'installation Installation Guide

Spleiss- und Spleisspatchgehäuse BELUGA S

Boîtier à fusionner et boîte à fusionner et à raccorder BELUGA S

Splice Enclosure BELUGA S

Produktansicht

Aperçu du produit

Product View



Wandbefestigung

Montage mural

Wall Mount

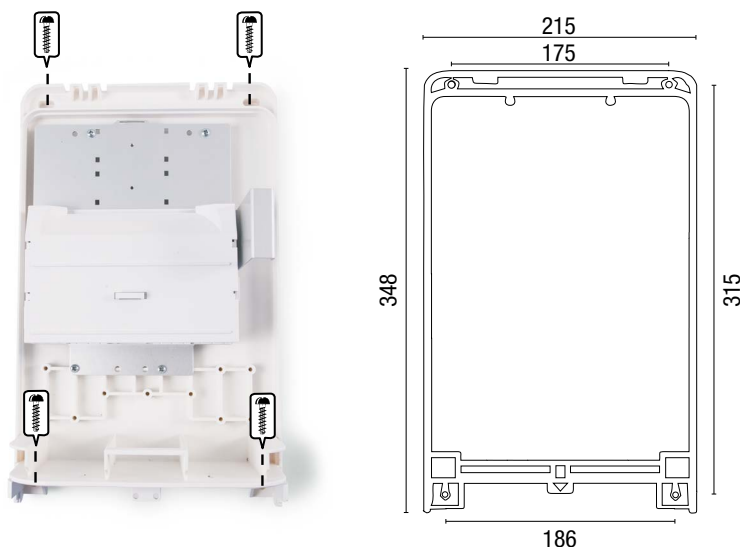

968661

Connect Com AG

Connect Com SA

info@ccm.ch

Connect Com GmbH

info@connectcom.de

Tel +41 41 854 00 00

Tel +41 21 804 66 22

www.ccm.ch

Tel +49 7022 9607 100

www.connectcom.de

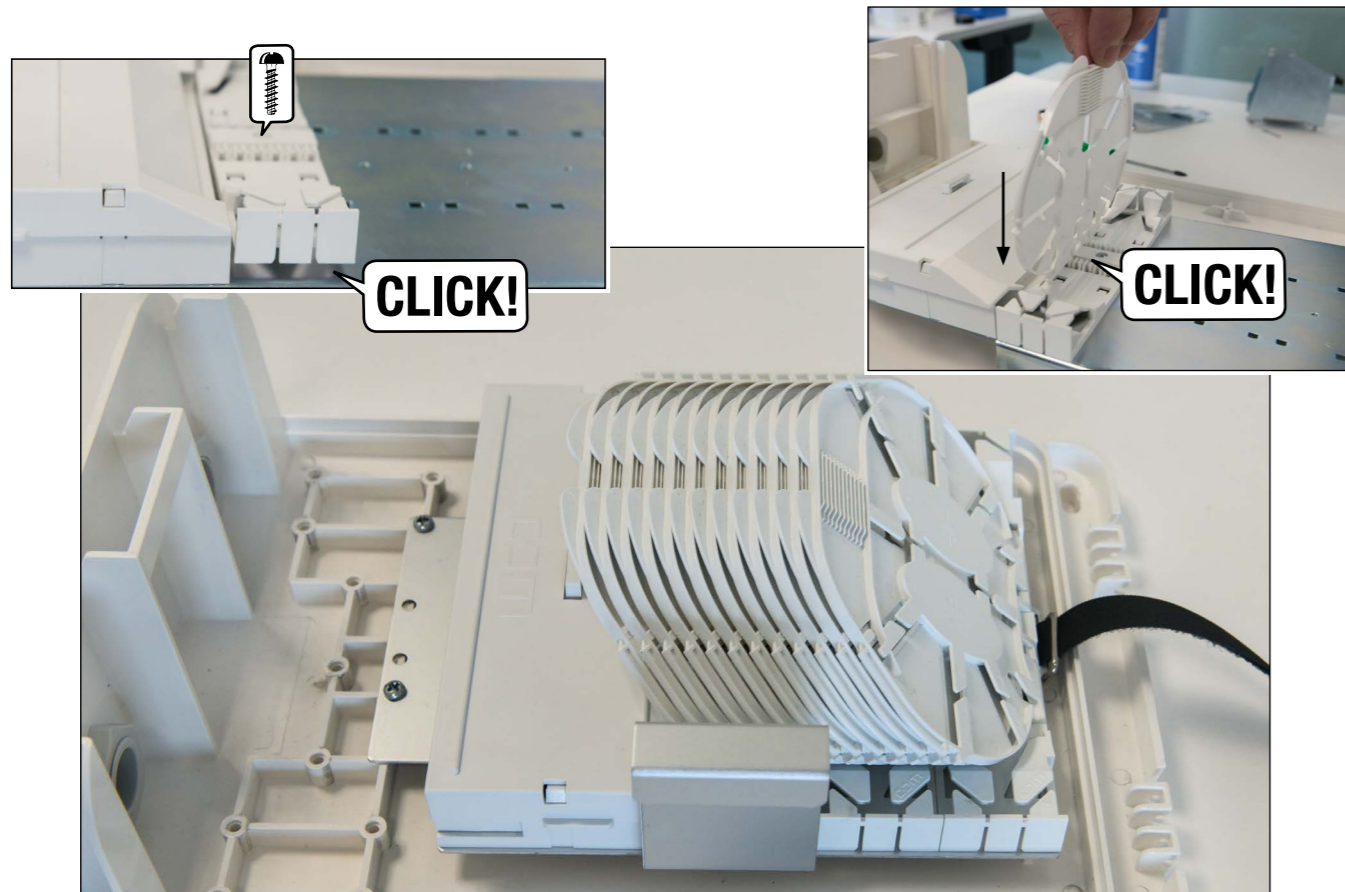
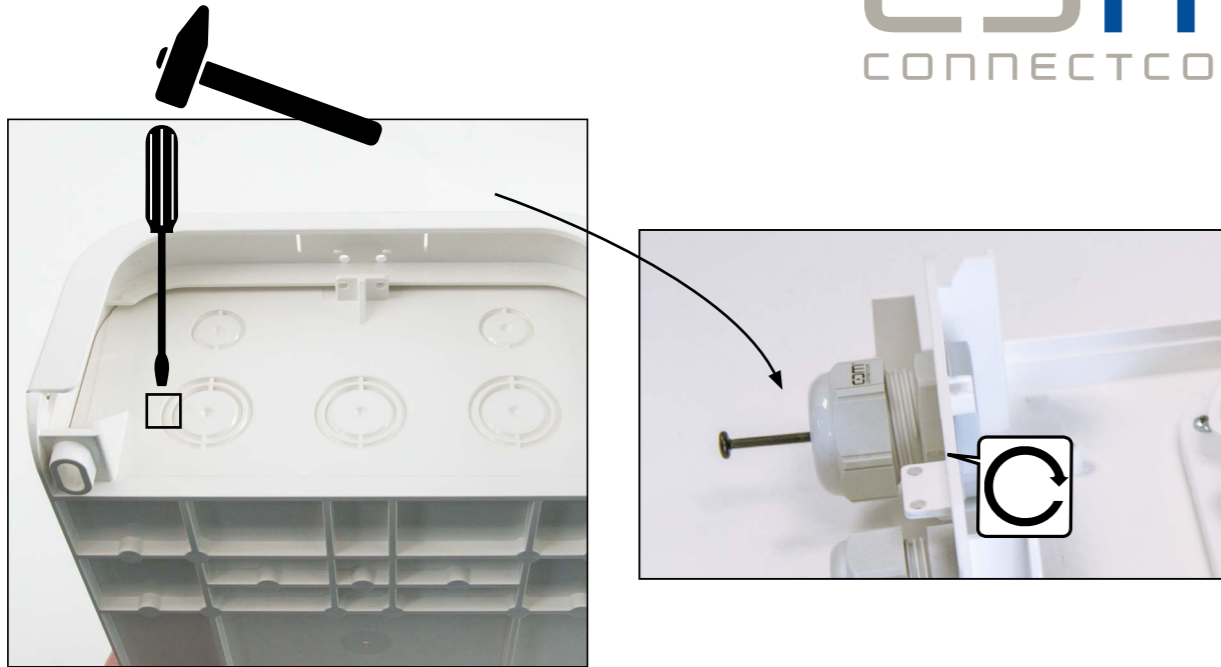

Einführung FTTH Kabel
 Insertion câble FTTH
 FTTH Cable Insertion

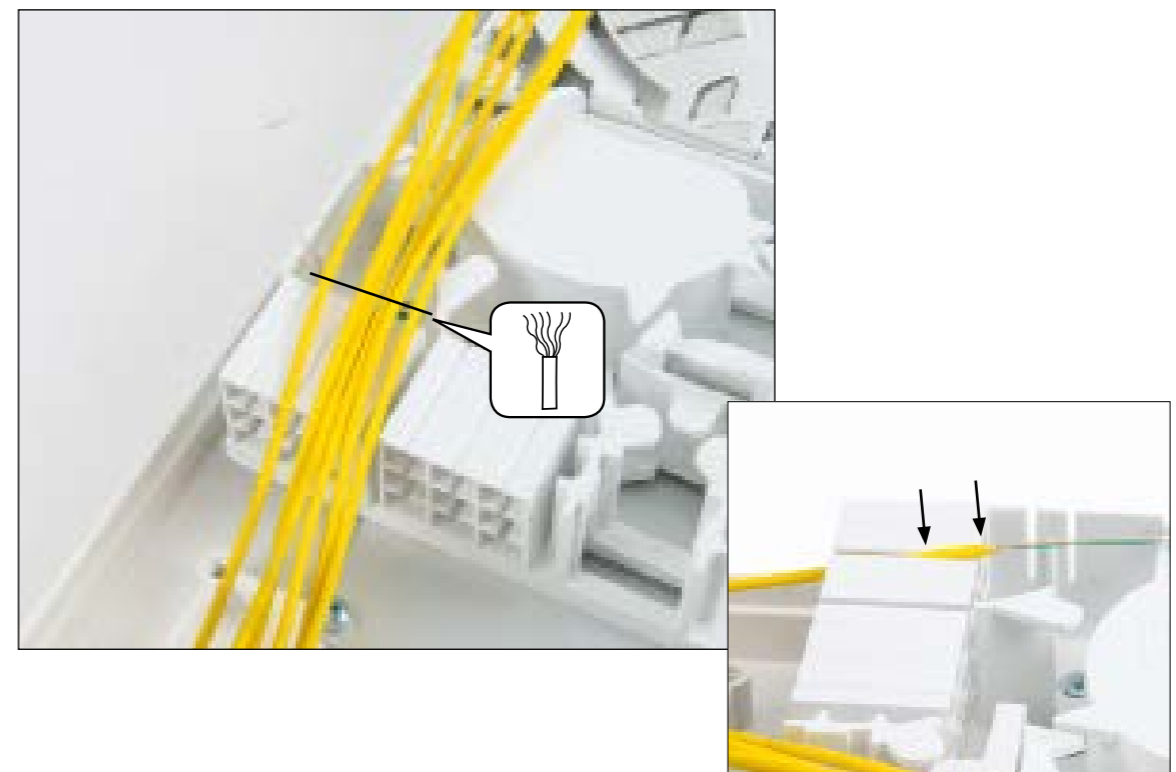

Einführung Bündeladerkabel
câble avec tubes de séparation
Insertion of Loose Tube Cable

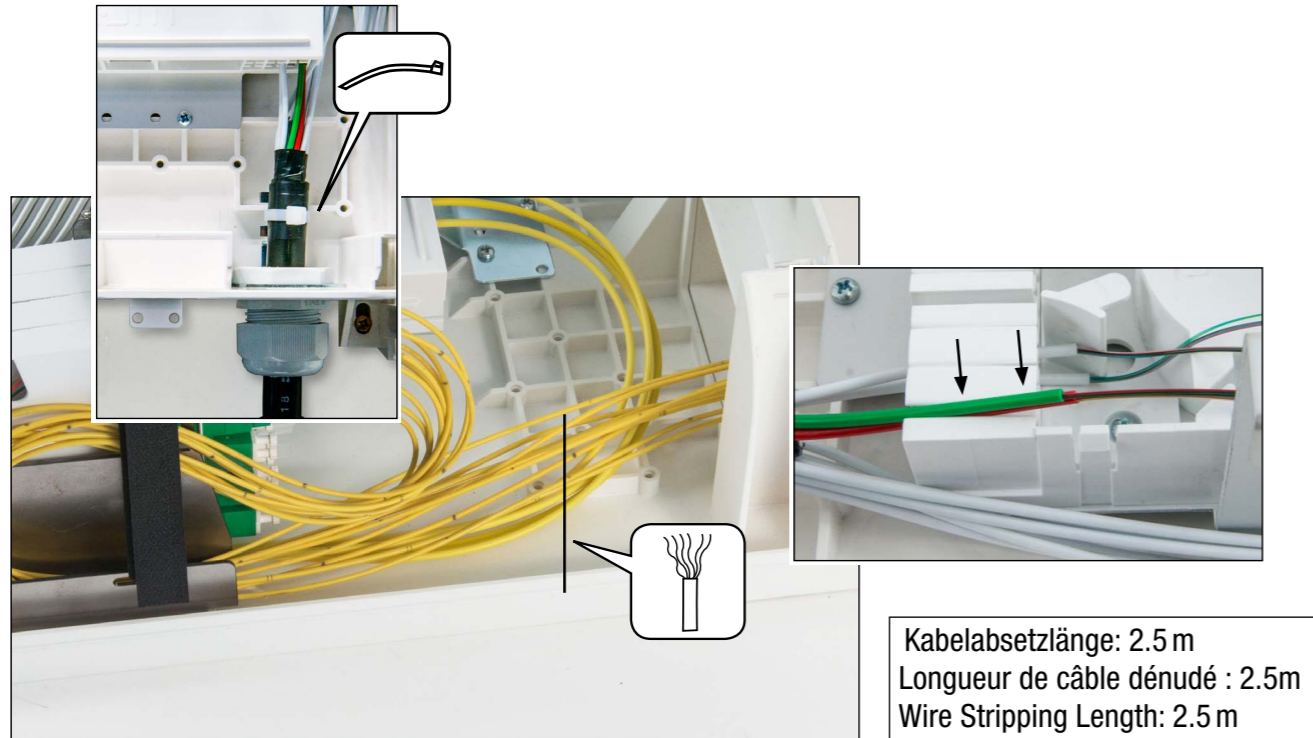

Kabelabsetzlänge: 2.5m
Longueur de câble dénudé : 2.5m
Wire Stripping Length: 2.5m

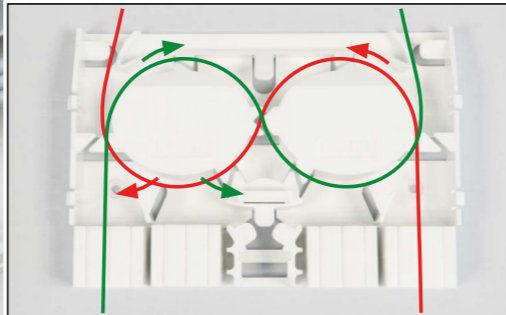
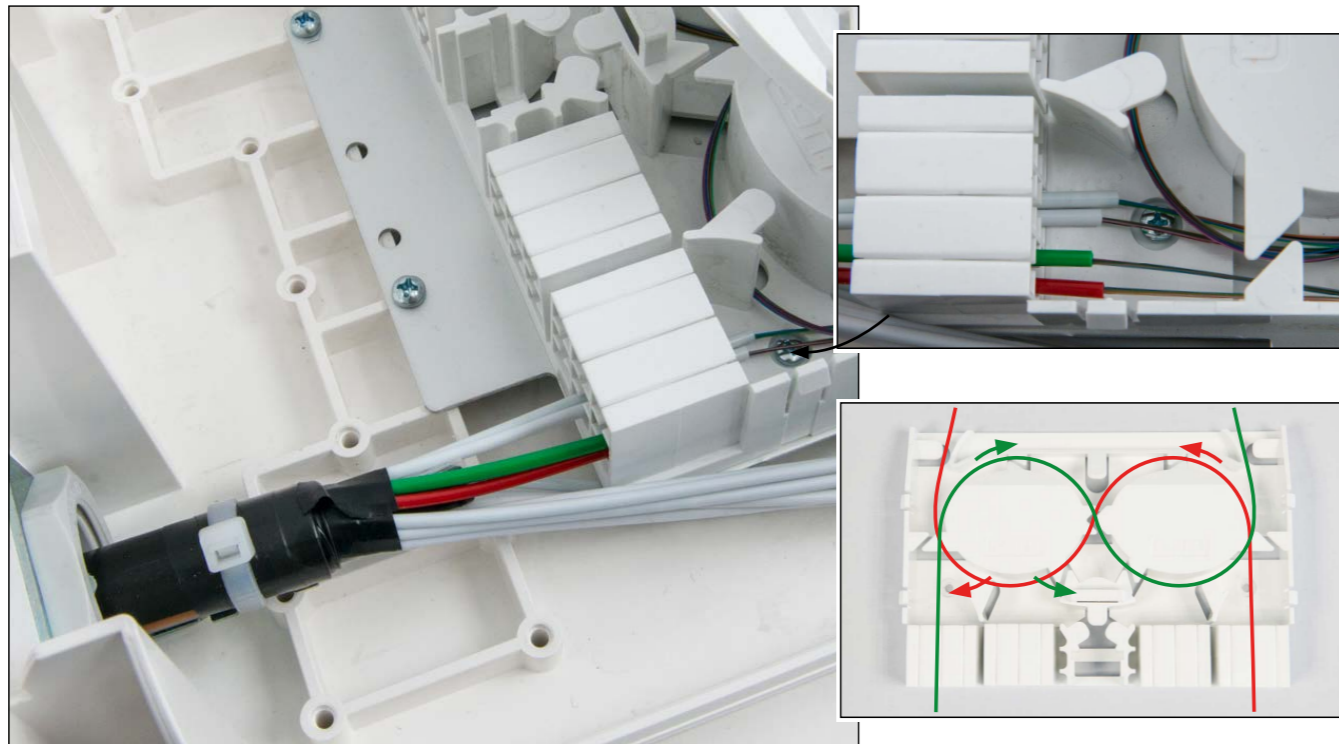

Einführung Patchkabel
Insertion cordon de brassage
Patch Cable Insertion

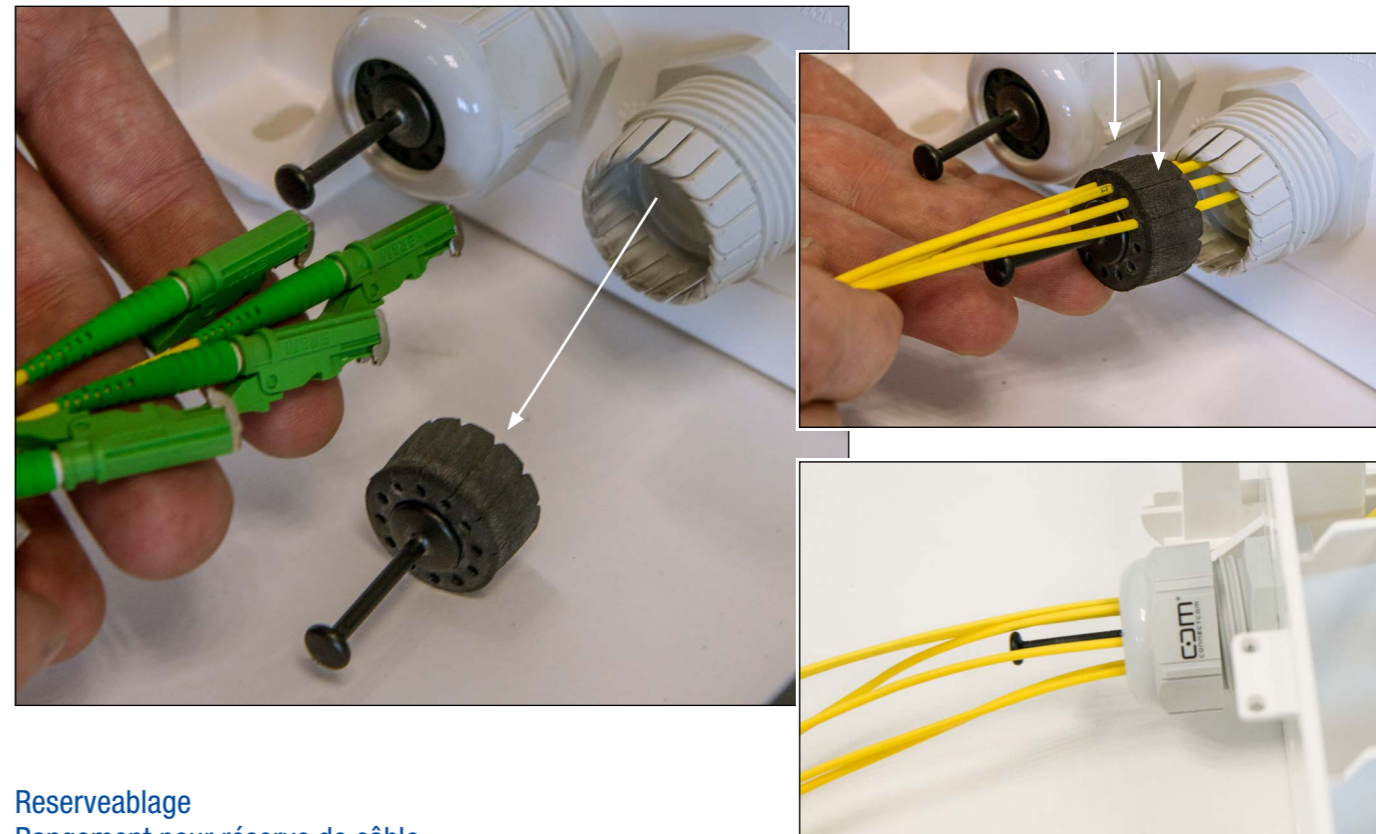

Reserveablage
Rangement pour réserve de câble
Compartment for Extended Length

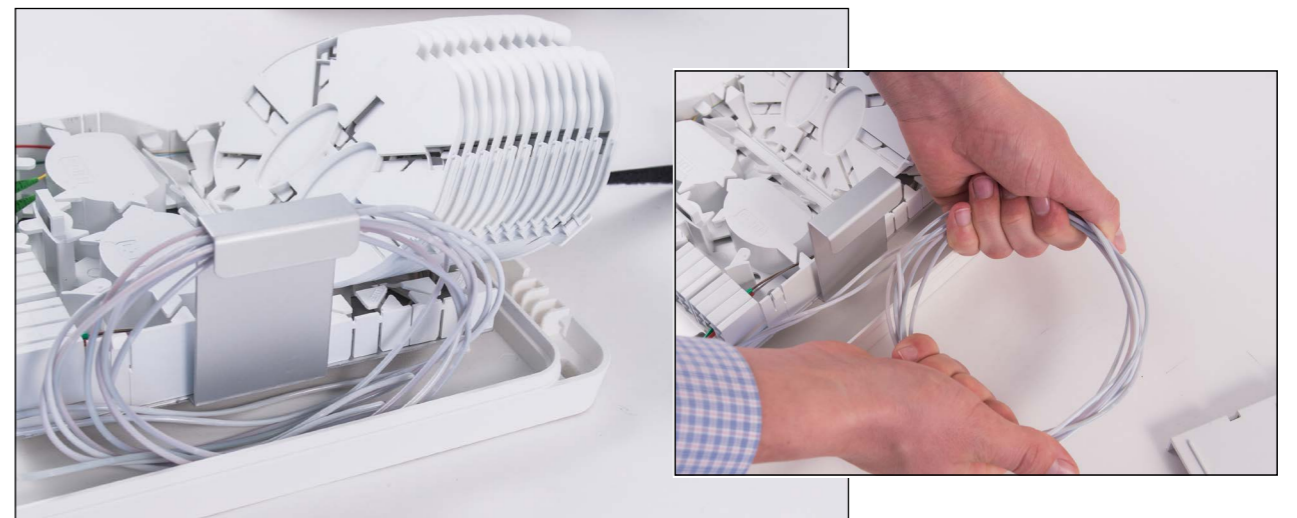

Variante mit Patchmodul
Variante avec module à raccorder
Option with Patch Module

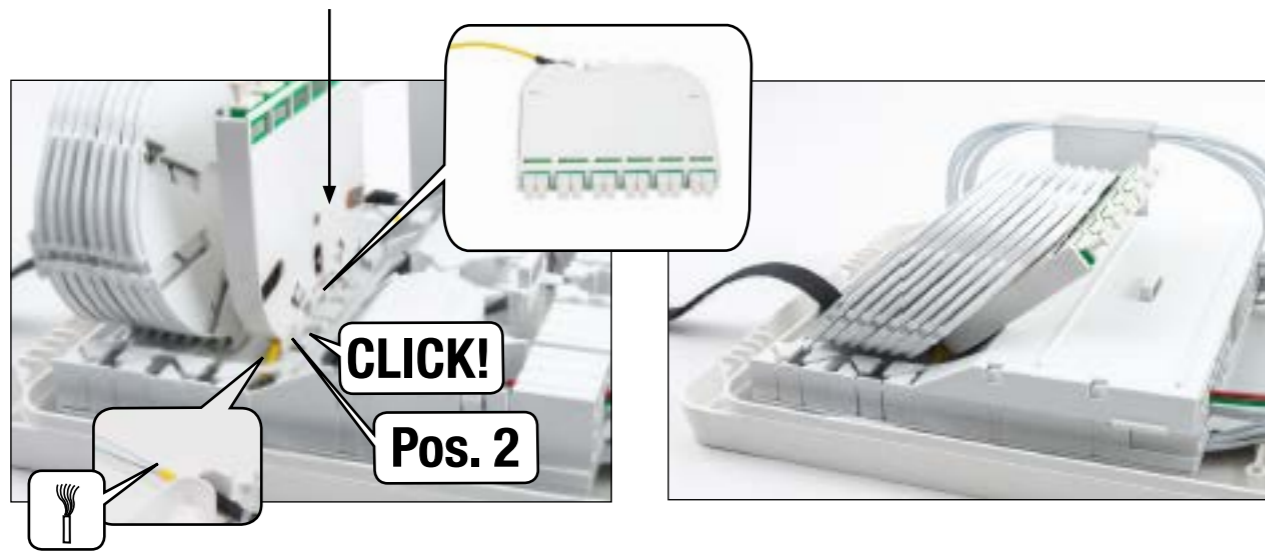
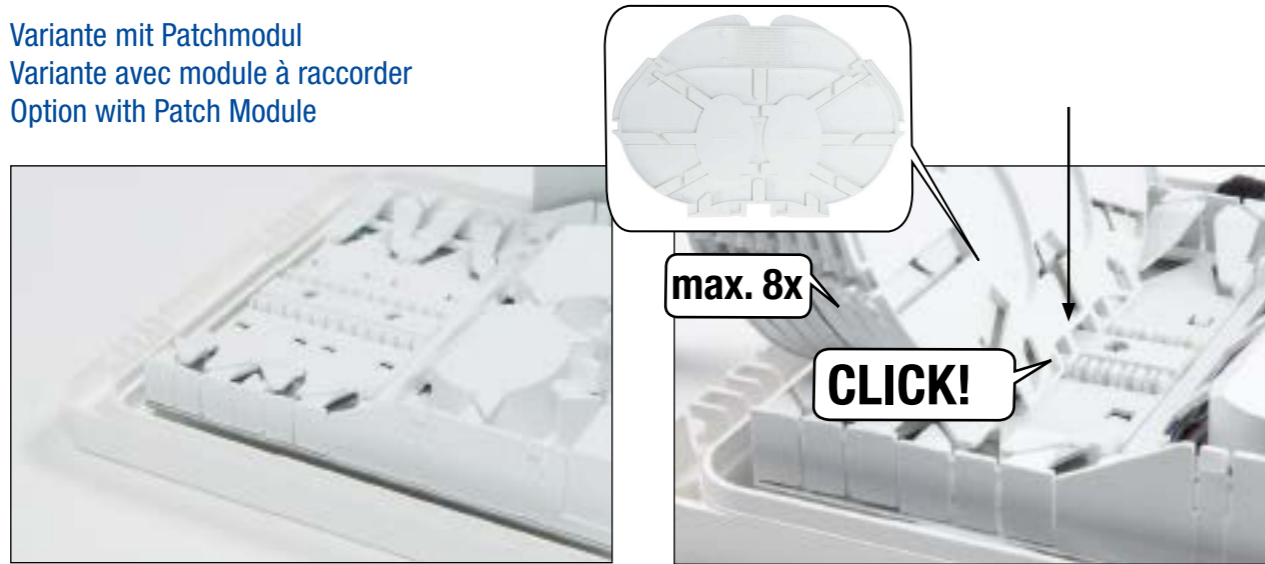

Variante Kupplungswinkel
Variante avec équerre pour raccords
Option with Coupling Bracket

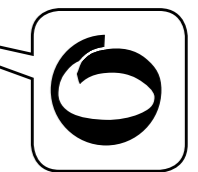
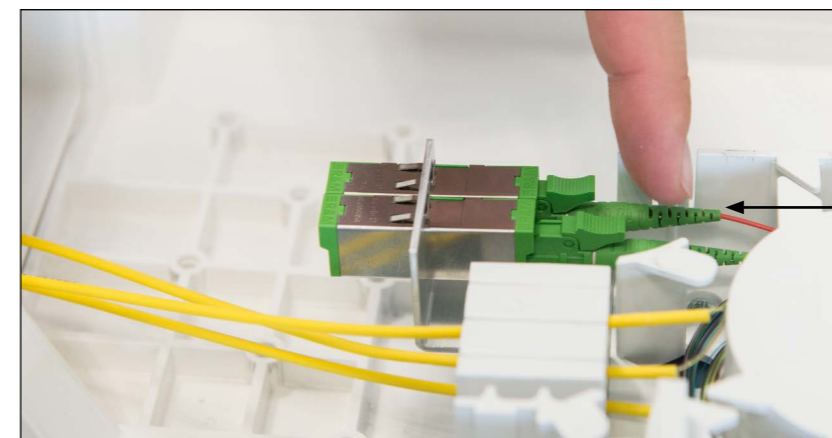
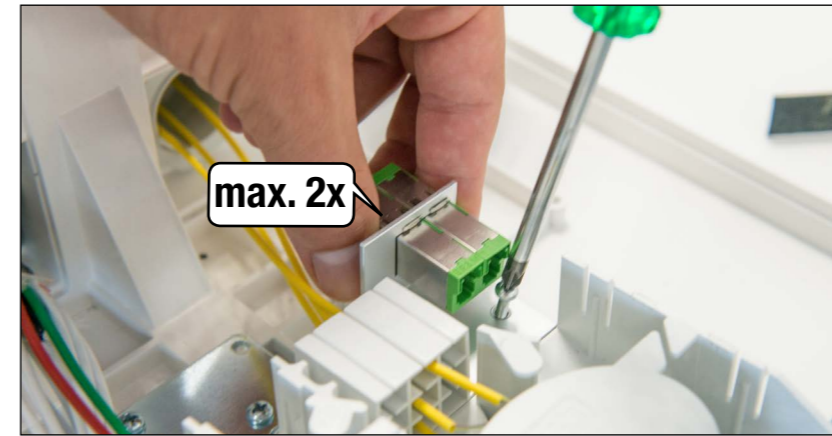

Variante Spleisspatchmodul
 Variante avec module à fusionner et à raccorder
 Option with splice patch module

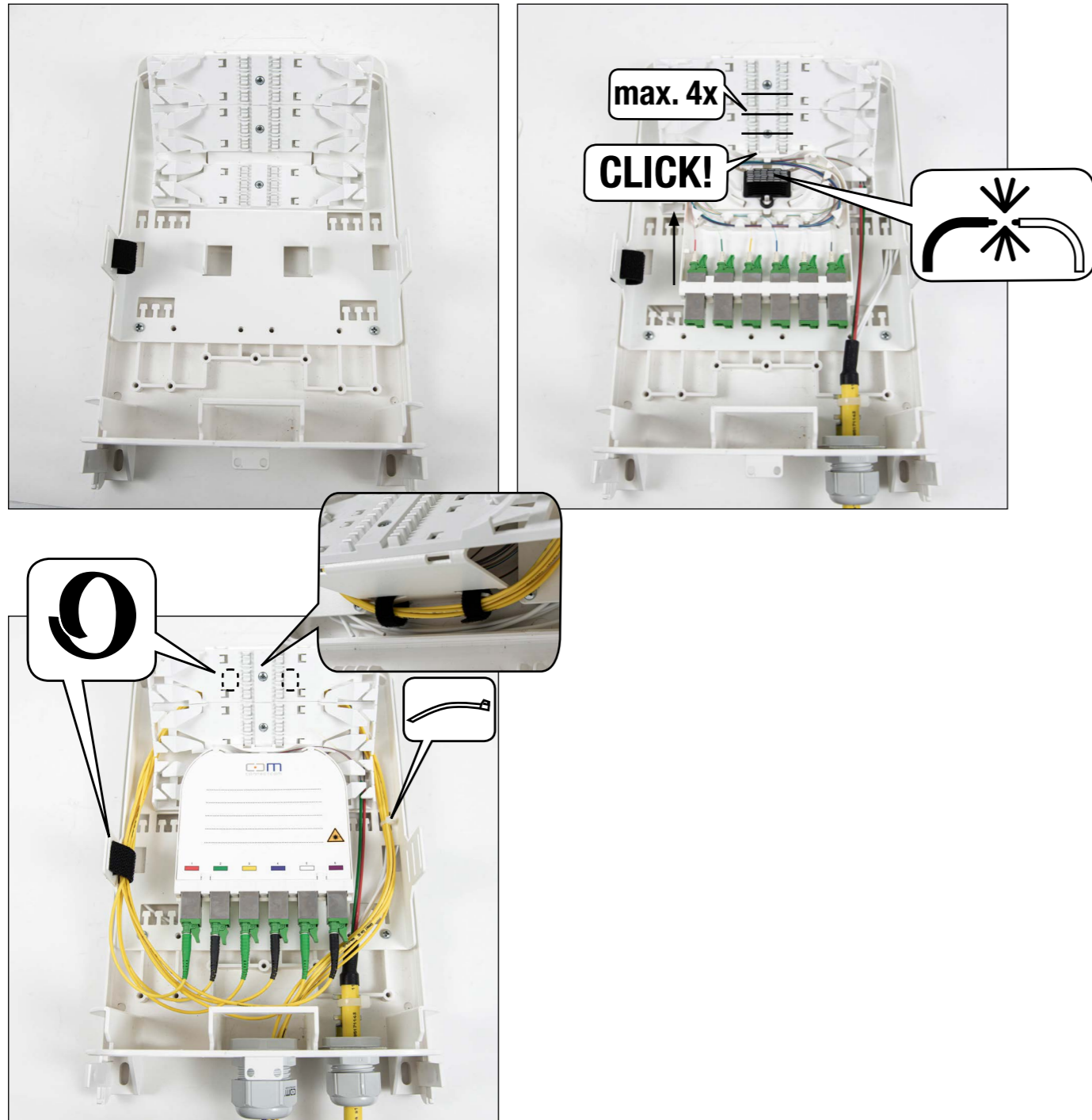

Faserführung in der Kassette
 Guide des fibres dans la cassette
 Fiber Guiding in Splice Tray

Ablagelänge:
 Rangement des longueurs:
 Length of Fiber Within Tray:

min. 1.0m
 max. 2.0m

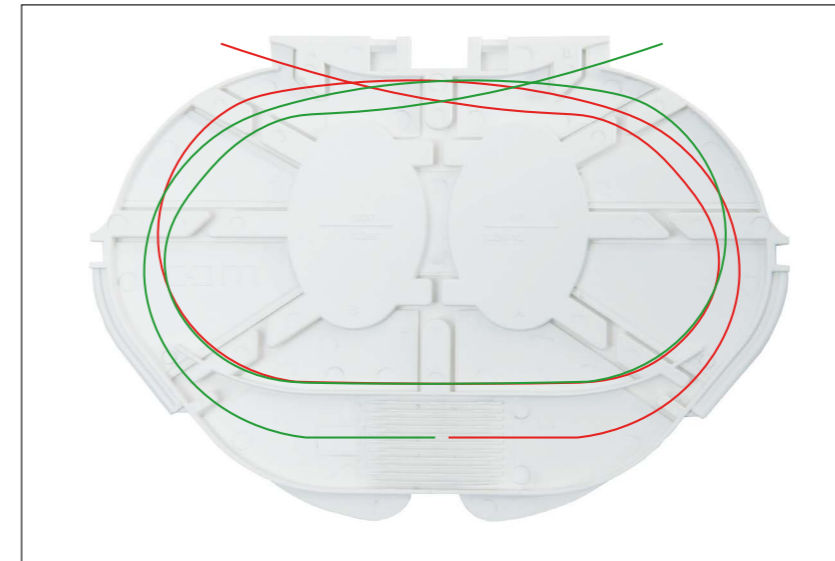

Werkzeug
 Outil
 Tools

Kabelabmantler
 Pince à dénuder pour câble
 Cable jacket slitter



Quaxialbrecher für LWL Röhrenchen
 Dénudeur coaxial pour tube
 Grey Buffer Tube Stripper



Kevlarschere
 Ciseaux kevlar
 Kevlar Cutter



Stripper
 Pince à dénuder
 Stripping Tool

